

PAINWEEK®

EXTRA EXPOSURE CATALOG



PHOTOS, SPECS & PRICING

Notes

- Creative branding shown here is for illustration purposes only; full specs are available upon request
- Sponsor responsible for providing hi-res print-ready electronic files by materials deadline
- All creative is subject to approval by both PAINWeek and the hotel
- All sponsorships includes production, materials, placement, and teardown
- PAINWeek is not at liberty to share creative/samples from past sponsors, except where displayed here

Registration Desk



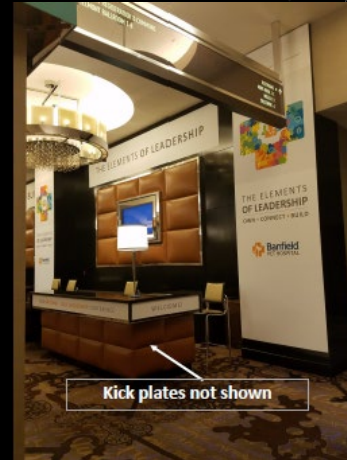
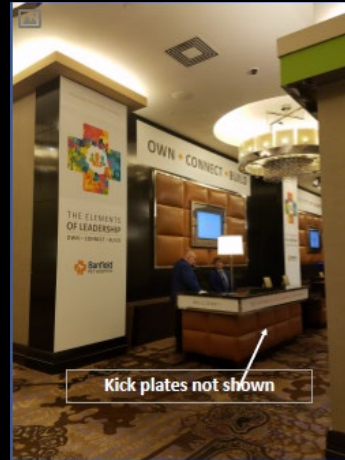

REGISTRATION DESK

- Located on level 4
- Exclusive to single sponsor
- Includes 3 columns (left, center, and right), 2 above monitor banners, and 4 desk kick plates (only 2 shown in photo to the right)
- **Sponsor cost \$25,000**

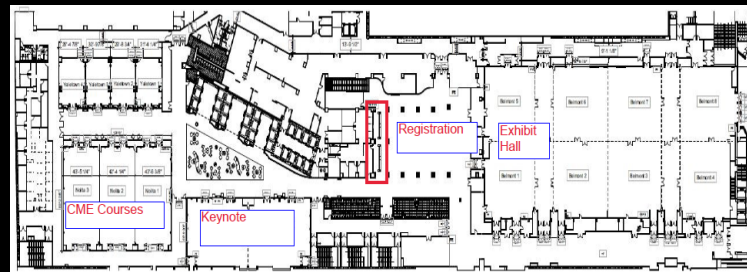

Elevators Banks



ELEVATORS BANKS

- Available only on Level 4 (registration, exhibits, CME sessions)
- 3 elevator bays available; 6 elevators per bay
- One sponsor per elevator bay; sponsor must cover all 6 elevators
- Sponsorship includes choice of elevator bay (based on availability), 6 pairs of elevator door panels, and 2 back panels; Creative can be duplicated across all doors or varied
- Sponsor branding not allowed inside elevator car
- **Sponsor cost \$10,000 per bay**

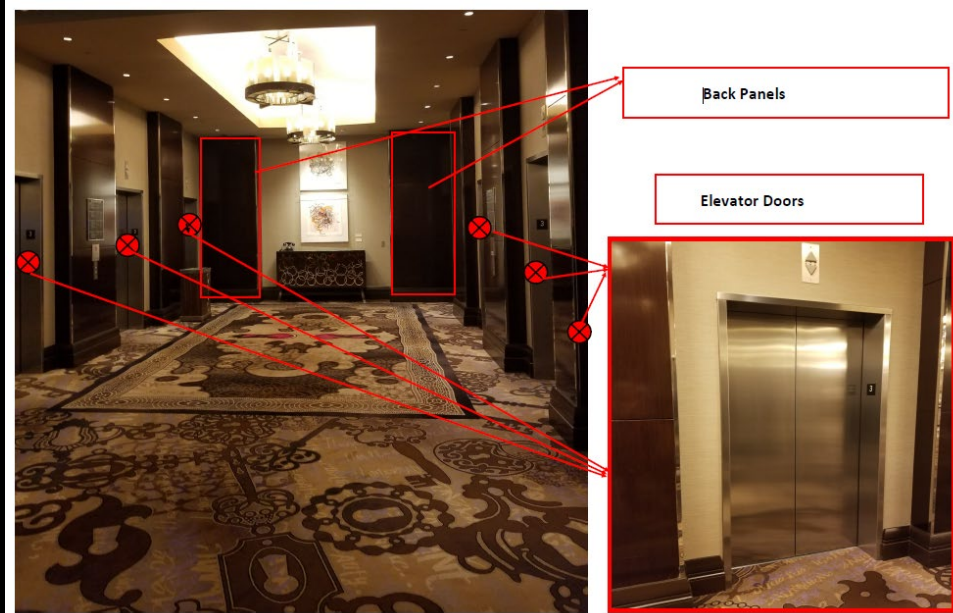

Elevator bay far left side.

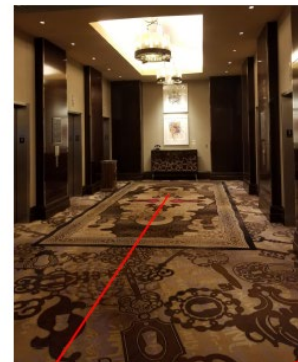

Elevator bay center.

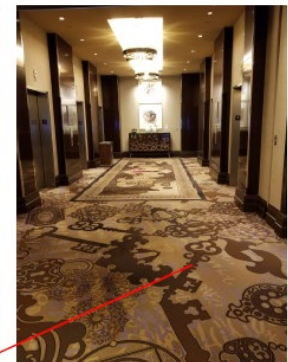

Elevator bay far right side.



Pillars



PILLARS

- Level 4 between exhibit hall and registration desk
- 3 sponsors allowed; 1 sponsor per pillar; Reserve all 3 pillars for complete exclusivity of registration area
- Sponsor receives pillar with 4-sides available for sponsor message
- **Sponsor cost \$5,000 per pillar (4-sides); \$15,000 for all 3 pillars**

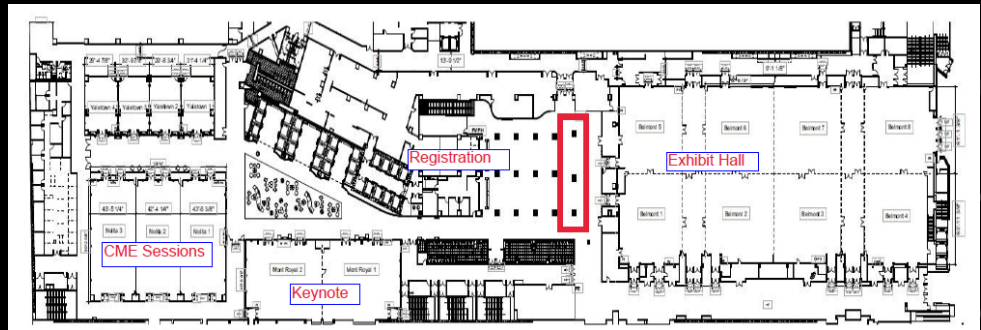
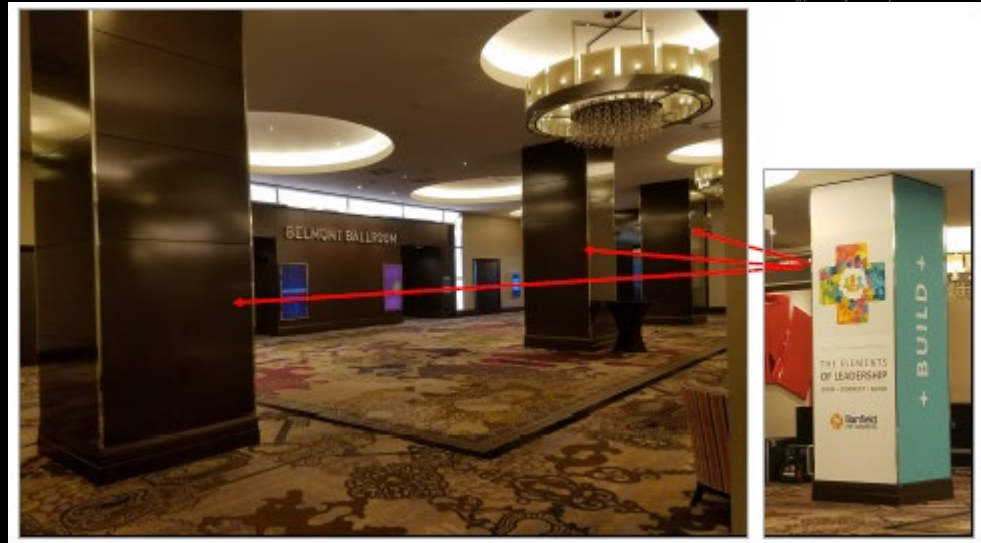

Column Toppers



LEVEL 4 COLUMN TOPPERS

- Level 4 registration area
- 12 columns available; One sponsor per column topper; Sponsor may reserve one or all toppers
- Column includes 4-sided branding area
- **Sponsor cost \$1,000**

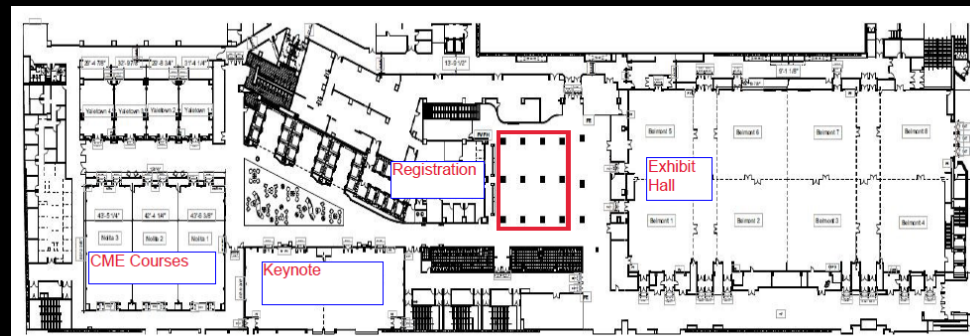

LEVEL 3 COLUMN TOPPERS

- Level 3 (CME courses and PDM symposia)
- One sponsor for all 12 columns; may not be individually sold
- Sponsor cost \$15,000 (12 columns)

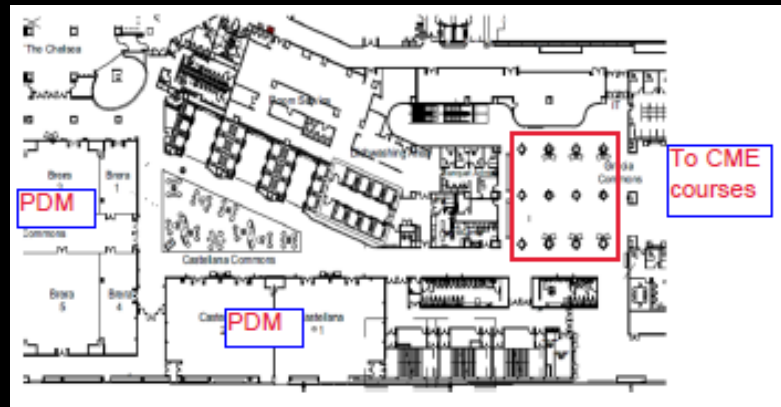

Mural Walls



MURAL WALL

- One location available on level 3 and one on level 4
- Single sponsor per level
- Banner with over head lights; built-out free-standing structure. Nothing adhered to wall
- Roughly 10' H x 30' W
- **Sponsor Cost \$20,000**

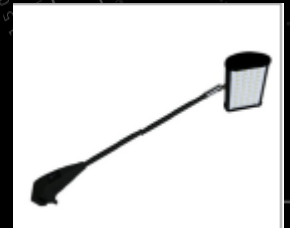

Branded Walls



EXHIBIT HALL ENTRANCE

- Outside main entrance of exhibit hall on level 4 in registration area
- Single sponsor
- Includes central square branding between video monitors as well as overheard branding seen to the right
- Hotel video monitors cannot be sponsored/branded; video monitors will display hotel information, events, and venue map
- **Sponsor cost \$10,000**

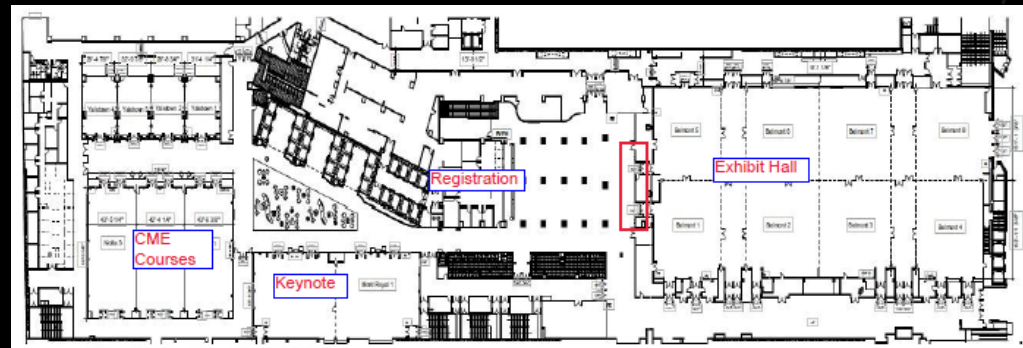

T-WALL RIGHT OF EXHIBIT HALL ENTRANCE

- Located on level 4 next to exhibit hall entrance and registration area
- Single sponsor
- Sponsor cost \$10,000

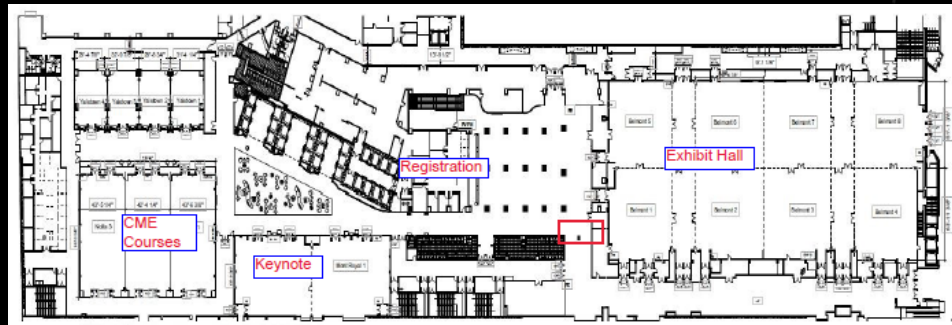

KEYNOTE ADDRESS ROOM

- Level 4 outside keynote address room and public seating area
- Single sponsor
- Visible from elevator banks
- Includes all space within red outline minus the cutout for video monitors
- Content on video monitors cannot be sponsored/branded; Video monitors display hotel information, events, and venue map
- **Sponsor cost \$10,000**

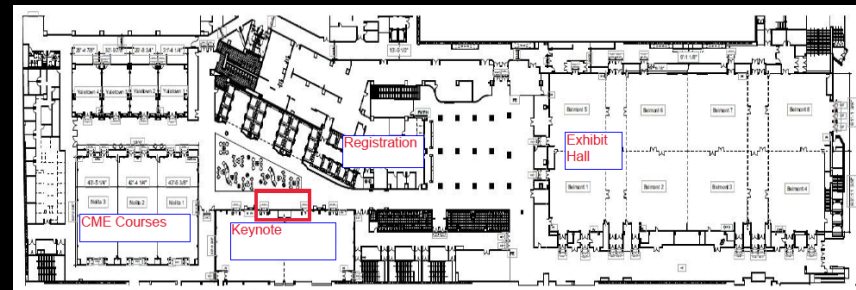
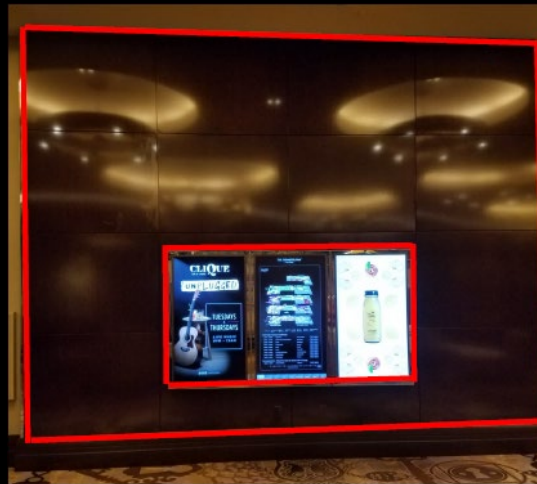

CME SESSIONS ENTRANCE GRACIA BALLROOMS

- Level 3 (CME sessions and PDM symposia)
- Single sponsor
- Sponsor cost \$10,000

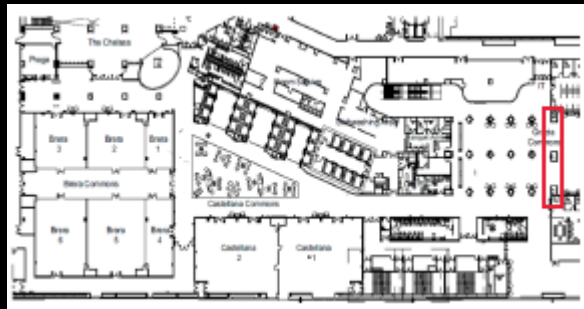

Conference Tables



COMMON AREA TABLES CASTELLANA COMMONS

- Level 3 (CME sessions and PDM symposia)
- Single sponsor
- 6 octagon-shaped tables as package; may not be individually sold
- Creative affixed above glass
- **Sponsor cost \$5,000 (6 tables)**



COMMON TABLES GRACIA COMMONS

- Level 3 (CME sessions and PDM symposia)
- Single sponsor
- 6 square-shaped tables as a package; may not be individually sold
- Creative affixed above glass
- **Sponsor cost \$5,000 (6 tables)**

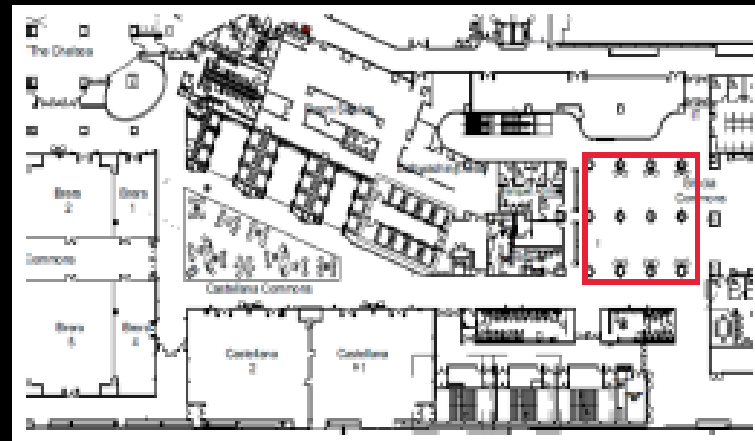
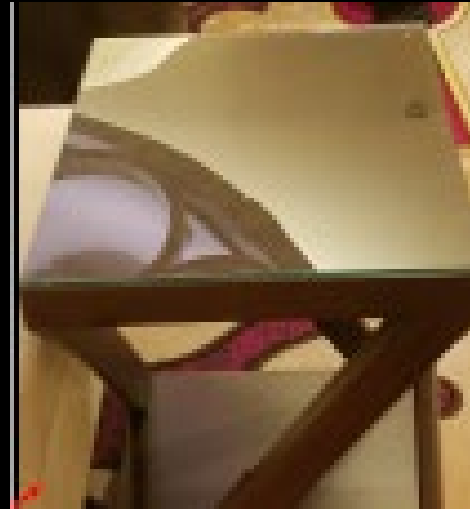

COMMON TABLES CONDESA COMMONS

- Level 2 (scientific posters)
- 8 total tables (4 round tables; 4 square tables) as a package; may not be individually sold
- **Sponsor cost \$3,750 (8 tables)**

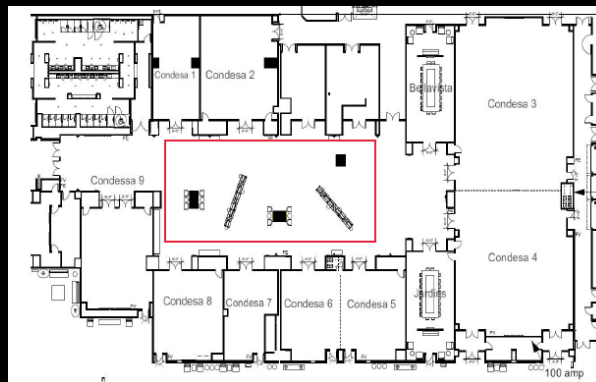

BRANDED CUBES

- Level 3 (CME sessions and PDM symposia)
- Level 4 (Registration, exhibits, keynote)
- Single sponsor per set of 3 cubes; multiple locations
- 4-sided branding per cube; 36" ea. side
- Red squares on map indicate location only and do not represent actual size of cube footprint relative to environs
- **Sponsor cost \$3,750 for 3 cubes on Level 3; \$5,000 for 4 cubes on Level 4**

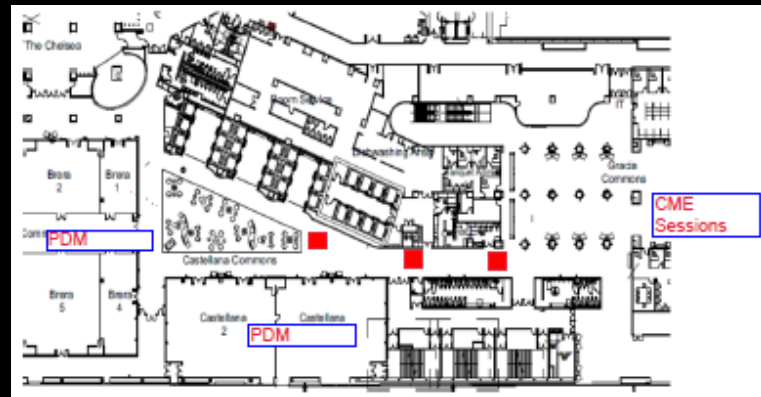
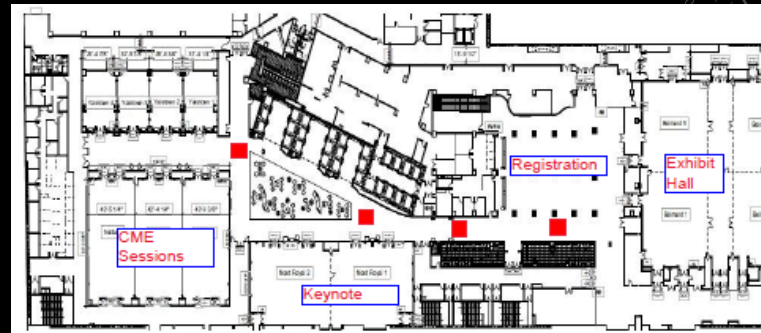

DIGITAL SCREENS

- Levels 3 and 4
- Single sponsor per screen
- 65" diagonal; Static image, up to 5 images in a loop, or 60 second video
- Displays live for duration of the conference
- **Sponsor cost \$10,000 per screen**

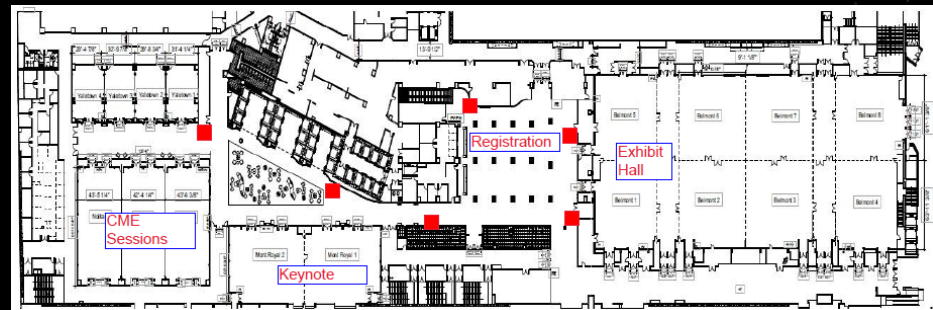
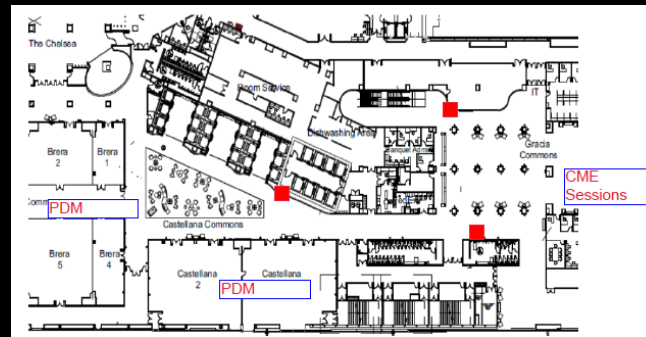

CHARGING STATIONS

- Level 3 and Level 4
- Single sponsor per station; 2 stations max per level
- Side and front panels available for branded printed graphics
- **Sponsor cost \$7,500 per station**

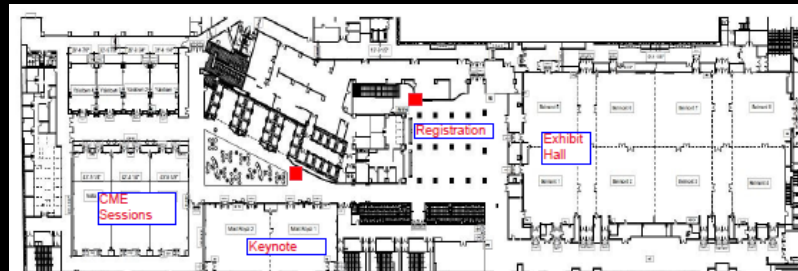
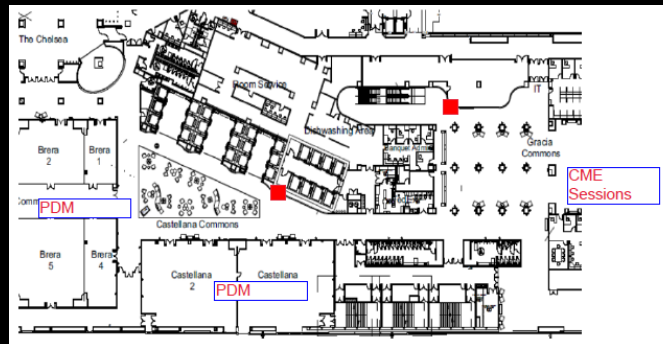

CONTACT INFORMATION

Sales

Sean Fetcho

sf@painweek.org

410-982-1193

Production

Redza Dempster

rd@painweek.org

973-415-5110